



# Haven Industries



## GrainSaver

# COMMERCIAL AUGERS

**Grain Saver® Commercial Augers** are designed for heavy duty grain handling applications. Special materials and design features make Grain Saver® the choice of farms elevators, and other grain centers. The heavy-gauge welded construction of the motor mount, screw, and safety cage, make an auger that is designed to keep going under the toughest conditions.

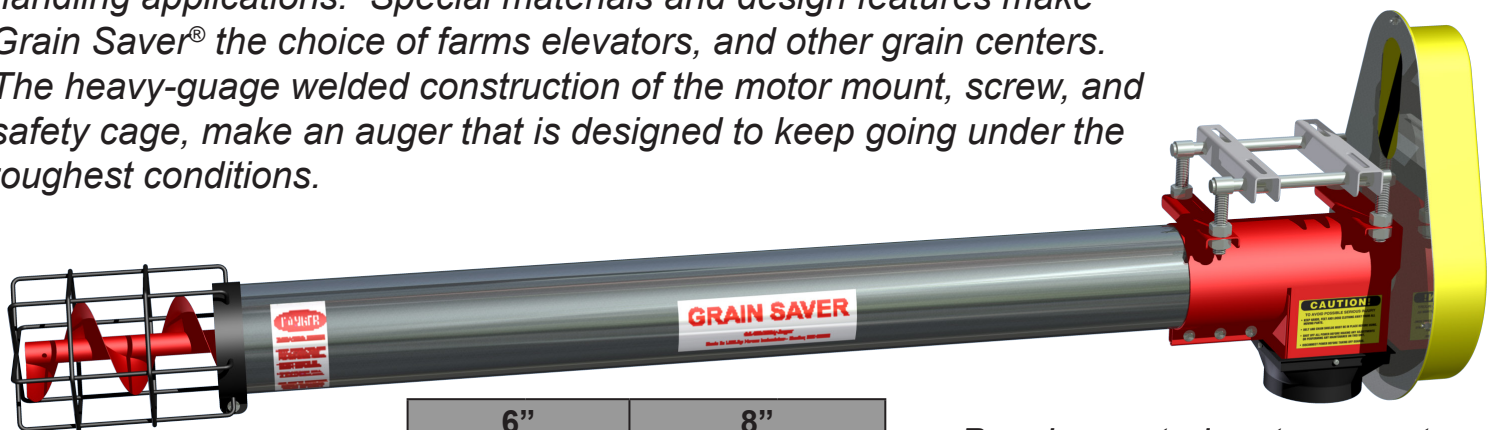

DESCRIPTION	LENGTH	6"		8"	
		PART #	WT(lbs)	PART #	WT(lbs)
Basic Section	6'	GS-606C	60	GS-806C	92
Basic Section	11'	GS-611C	95	GS-811C	154
Basic Section	16'	GS-616C	125	GS-816C	220
Basic Section	21'	GS-621C	170	GS-821C	265
Extension w/ sleeve	5'	GS-605C	45	GS-805C	65
Extension w/ sleeve	10'	GS-610C	76	GS-810C	115
Extension w/ sleeve	15'	GS-615C	112	GS-815C	165
Extension w/ sleeve	20'	GS-620C	132	GS-820C	200
Mounting Bracket		MBA06	5	MBA08	8
14" x 14" Intake Hopper		HP06	45	HP08	45

- Powder coated motor mount
- Poly belt guard
- ABS discharge spout
- Easy assembly process
- Steel spider-web safety cage
- 14 Ga. galvanized steel tube

Extensions are complete with a galvanized connecting sleeve and bolted connect shaft for easy installation.

Authorized Dealer:

Please see our full line of accessories to perfect your installation. Visit our website or ask your sales representative for product information.

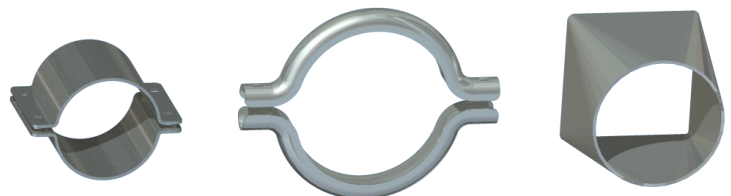

# **COMMERCIAL TRANSFER & BIN TOP AUGERS**

Our Commercial line of multi-purpose augers are custom built to requested specifications. All augers come standard with a heavy duty power head drive with hardware kit for motor installation. Hoppers are available upon request.

## **TUBE STYLE AUGERS**

- Available in 6", 8", 10" & 12"
- Cut to exact desired length
- Optional hanger bearings every 10 feet
- Easy installation process
- Heavy duty all welded construction.



## **U-TROUGH AUGERS**

- Available in 10" & 13" U-Trough
- Heavy Duty 12 Gauge Steel
- Built to any desired length
- Optional hanger bearings every 10 feet
- Easy installation process

